



Smoking trolleys
for 20 trolleys/ h
electrical

Art.-Nr.: 1.577.66

Smoking trolleys 20 for trolleys/ h electrical

The machine is created for washing of standard smoking trolleys. It is entirely made of stainless steel type DIN 1.4301 (AISI 304) grade with permission for contact with food- according to the standard.

Loading and unloading processes are manual. Electromagnetic interlock, preventing the opening of the doors, during the washing process. Before starting the washing process, the trolleys are steamed (in a steam heating mode).

The washing process is performed by water circulation in a closed filtered cycle incl. a suitable detergent. General water supply is used for rinsing. The duration of the washing and rinsing programmes can be adjusted by the operator, depending on how dirty the trolleys are. Machine control is entirely computerized- SIEMENS SIMATIC controller.

Options:

- Automatic system for detergent filling and dosing (with concentration measurement)
- As an option, the machine can be manufactured dual (for washing of two trolleys simultaneously)
- And pass-through (with second door on the back side)

Art.-Nr.: 1.577.66

Technical data:

capacity:	20 trolleys/ h
power supply:	400V, 50 Hz
installed power:	electrical: 41 kW
water temp main wash:	20-65°C
water inlet:	1R"
water pressure in pipe:	3 bar
water outlet:	2R"
tank:	400 L
pump performance:	62 m ³ /h
pumps pressure:	3-4 bar
power gear engines:	7,5 kW
protection type:	IP 55
protection type:	IP65
steam inlet pressure:	min. 2 max. 12 bar (max. 130°C)
heating:	33 kW
weight:	1.250 Kg
dimensions (LxWxH):	2093 x 1830 x 3200 mm

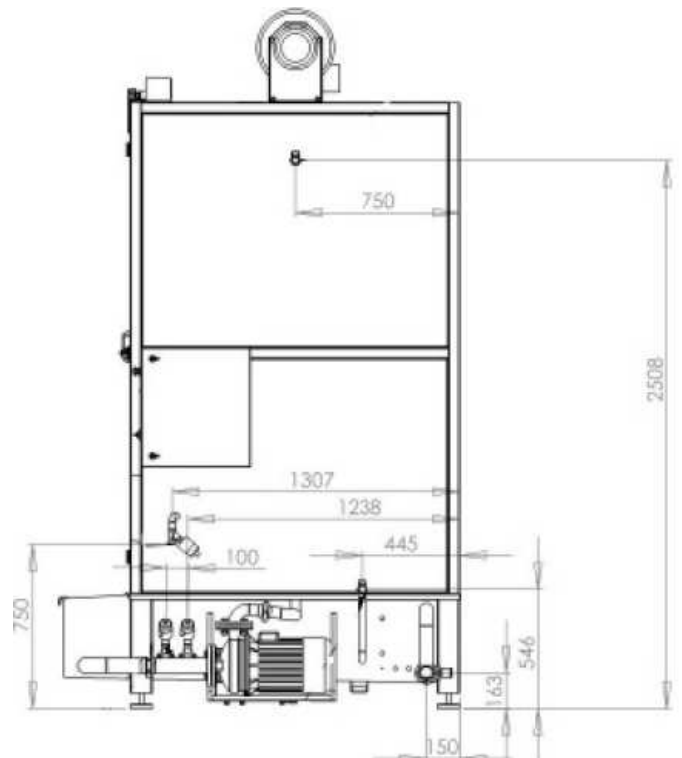
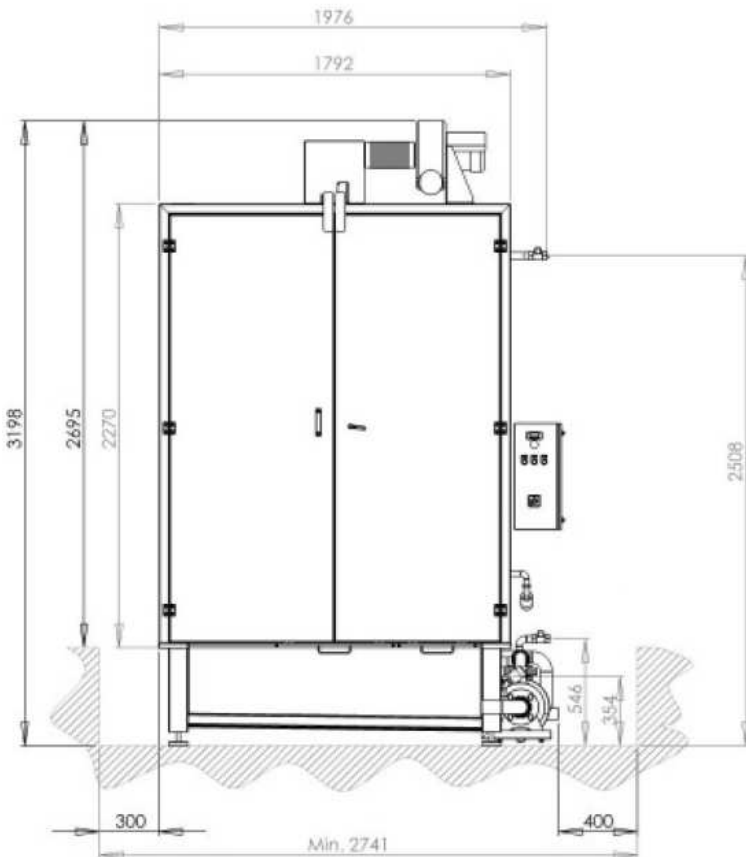
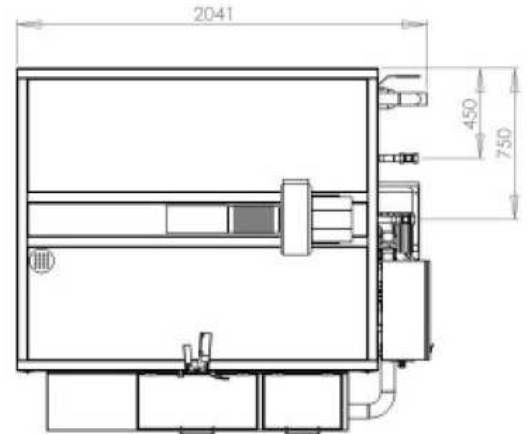

3D drawing

